

- HOSEBED CAPACITIES
- ① 1000' OF 5.00" D.J.POLY HOSE
 - ② 500' OF 3.00" D.J.POLY HOSE
 - ③ 500' OF 3.00" D.J.POLY HOSE

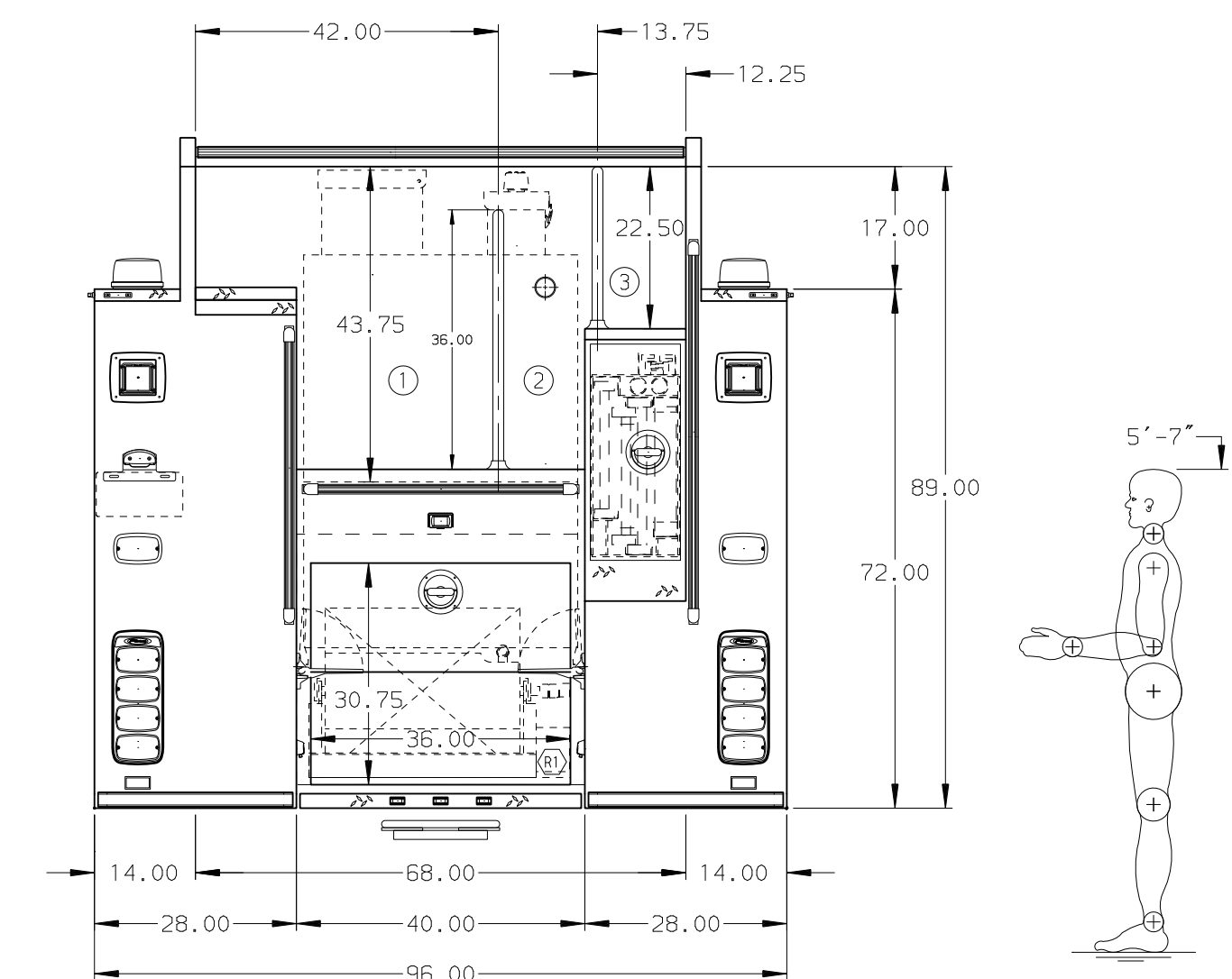

ALUMINUM BODY

SIDE ROLL & FRONTAL IMPACT PROTECTION

NOTE
DIMENSIONS SHOWN ARE APPROXIMATE AND ARE SUBJECT TO MINOR DEVIATIONS AS MAY OCCUR OR BE NECESSARY IN CONSTRUCTION. MINOR DETAILS NOT SHOWN.

				CHASSIS DATA	TITLE	1250-D-500 WATER/20 FOAM, 152" FH FLDR, CROSSLAYS DELUGE, LADDERS BESIDE TANK, FOAM SYSTEM, NOTCHED CAB	JOB NO.	PRELIMINARY
				MAKE	FOR	COLLEVILLE FIRE DEPARTMENT	SCALE	DATE
				PIERCE		SIDDONS-MARTIN EMERGENCY GROUP	DRAWN BY	22SEP15
				MODEL		BID #499 TRAVIS OWNBY	CHECKED BY	-
REV	DATE	BY	CH	IMPEL FR	DWG NO.	04-1876	SHEET SIZE	SHEET NO.
							D	1 OF 1